

SIMPLE EVALUATION MODEL FOR LONG TERM DEBRIS TRANSPORT VELOCITY IN THE TORUS OF A MARK I CONTAINMENT

Jens-Uwe Klügel¹

Kernkraftwerk Gösgen-Däniken, Switzerland

Introduction

After the Barsebäck 2 strainer clogging incident from 28 July 1992, a first review of the design features of a Mark I containment and the thermal insulation typically employed revealed a potential for the transportation of larger amounts of insulation into the wetwell (torus) of the containment during a LOCA. Although Switzerland took a quick decision to increase the strainers of all BWRs till the end of 1993 (as it was performed by the Swiss Utilities) for the meantime it was necessary to develop tools for assessing the effectivity of accident management actions proposed by the utilities for the existing (old strainer) design. Among others tools a simple evaluation model for assessing the transport velocity of insulation debris caused by the suction of operating strainers was developed, which was applied for a BWR with a Mark I containment and can as well be applied for sump pool conditions of a PWR (submerged sump strainers).

Model description

Basic modelling assumptions

Based on a review of the containment design features and the allocation of the torus strainers in relation to the possible entry paths of insulation it was concluded, that the following assumptions for long term operation of emergency core cooling systems can be applied to develop the model:

1. The flow in the torus can be modelled as a multidimensional steady state potential flow with distributed flow sinks (strainers).
2. The distance between the strainers is large enough to neglect the effects of superposition of the flow fields in the immediate surrounding of the strainers.
3. The flow sinks are modelled to have point shape and are located at the elevation of the strainers. The water below the strainers does not take part in the water exchange between the different torus layers.

1. The work presented was performed while the author was working with the Swiss Nuclear Safety Inspectorate.

Basic equations

The model developed based on the assumptions above can be solved analytically for the spatial velocity distribution of water in the torus. The corresponding equations (in polar coordinates) for the velocities in radial and vertical directions are given below. Q is the volumetric flow of the system taking suction from the strainer of interest.

$$C_r = \frac{Q}{(2 \cdot \pi \cdot z \cdot r)} \quad (1)$$

$$C_z = C_{\text{strainer}} \cdot \frac{A_{\text{strainer}}}{A_{\text{torus}}(z)} \quad (2)$$

Goals and object of the investigation

The model was used to estimate the transport velocities of insulation material (rockwool) floating in the torus of a BWR with Mark I containment. The main goal of the investigation consisted in the evaluation of the success chances of accident management measures like:

- throttling of suction flow;
- temporarily transferring ECCS injection to the cold condensate storage tank interrupting suction from the torus;
- restarting suction from torus after drain of cold condensate tank assuming settlement of insulation material.

Figure 1 shows a cross section of the plant containment.

In the original design (meanwhile the strainers were replaced) the plant possessed three small suction strainers spatially separated from the blowdown lines in different segments of the torus. The plant of concern has 6 different trains of ECCS systems:

- TCS – torus cooling system – 2 trains.
- CS – core spray system – 2 trains.
- ALPS – alternate low pressure system – 2 trains.

The total suction flow in case of operation of all trains consists of $0.43 \text{ m}^3/\text{s}$. The minimal suction flow in case of operation of one train of the torus cooling system and one train of ALPS consists of $0.085 \text{ m}^3/\text{h}$. All strainers are connected to a common ring line below the torus area subdivided to the different system trains. The free flow area of one strainer was 0.206 m^2 . The distance between the strainers and the next blowdown line into the torus is 8.1 m in horizontal direction and 1.71 m in vertical direction. The strainer surface was allocated 3.58 m below the normal torus water surface.

The suction strainer thus was well separated from the possible entry points of insulation with the blowdown flow.

Results and conclusions

A large set of calculations for different operating conditions of emergency core cooling systems was performed. Table 1 gives an overview of the conditions considered.

Table 1. Operational conditions investigated

ECCS suction flow	Number of strainers in operation	Comment
0.430 m ³ /s	3	Maximum suction flow with all strainers in operation
0.430 m ³ /s	1	Maximum suction flow with 2 strainers clogged
0.085 m ³ /s	3	Minimum suction flow with all strainers in operation
0.085 m ³ /s	1	Minimum suction flow with 2 strainers clogged

Figures 2-7 show the velocity distribution in the surroundings of a suction strainer for different operating conditions. Based on a comparison with typical settlement velocities of thermal insulation debris (mainly rockwool of different age) it was demonstrated, that the flow suction from the strainers has only minor effect on the settlement velocity of the debris. The suction effect in radial direction is also very limited, once stabilised flow conditions are achieved in the torus. On the other hand this means, that material which is able to float (old insulation material) can keep floating for a very long period of time not being directed to the strainers. Only material transported close to the strainer position is expected to participate in a potential strainer clogging. Spatial separation of strainers from the blowdown lines gives some reasonable protection against strainer clogging. The largest uncertainty remained was the distribution of thermal insulation during and immediately after the blowdown phase of the accident.

With regard to accident management actions it was concluded:

- that flow reduction for operating emergency core cooling systems is an effective measure to reduce the risk of strainer clogging;
- that it is unlikely, that once settled debris, for example after an interruption of ECCS operation or back flushing will relocate to the strainers;
- that the accident management actions implemented by the utility as an intermediate measure:
 - Injection from an alternate water source (cold condensate storage tank) allowing to stop suction from the torus.
 - Back flushing of strainers from cold condensate system is efficient to limit the consequences of a LOCA accident within the regulatory safety limits.

On the other hand, it was concluded that human interaction may be necessary within the first 30 minutes after an accident to avoid partial clogging and to circumvent the uncertainty related to the initial insulation distribution in the torus. This situation was not in compliance with the deterministic 30 min-rule (Swiss Regulation R-101), requiring that design basis accidents shall be governed mainly by automatic means not allowing for not safety directed human interactions (like throttling or turning off ECCS-systems) during the first 30 minutes of an accident.

That's why in 1993 the effective strainer surface of all BWRs in Switzerland was enlarged substantially.

Figure 1. Mark I containment

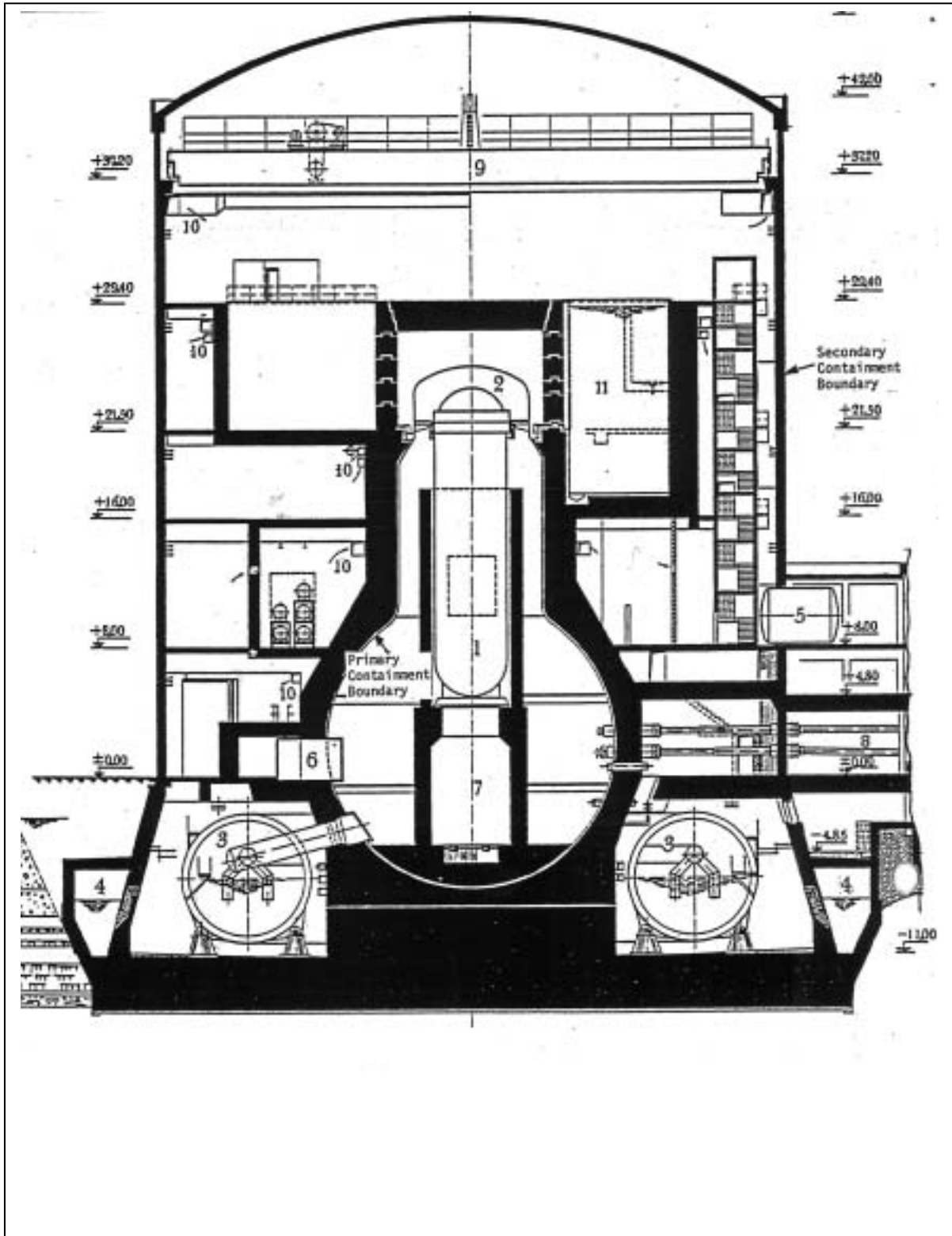

Figure 2. Radial velocity distribution, $Q = Q_{max}$, 1 operating strainer

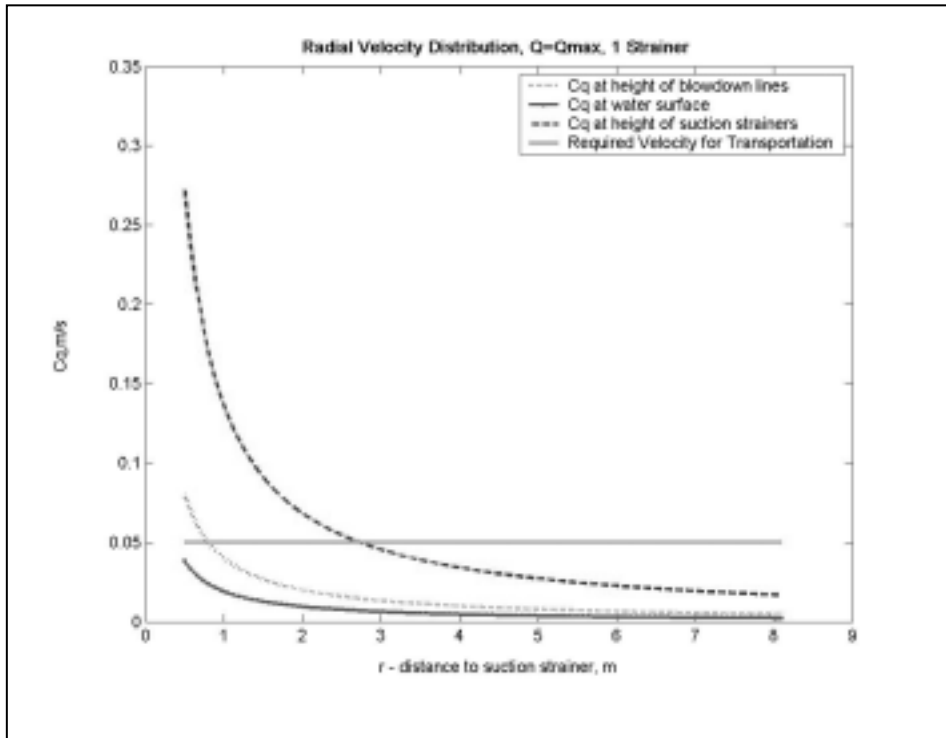

Figure 3. Radial velocity distribution, $Q = Q_{max}$, 1 operating strainer – Surface plot

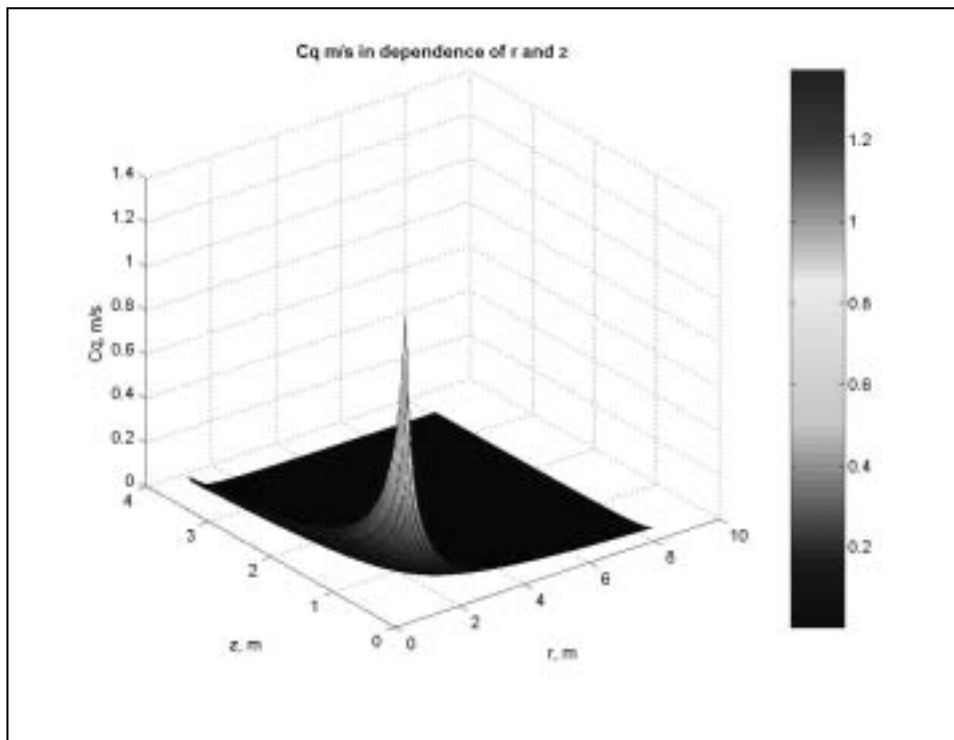

Figure 4. Axial velocity distribution, $Q = Q_{max}$, 1 operating strainer – Surface plot

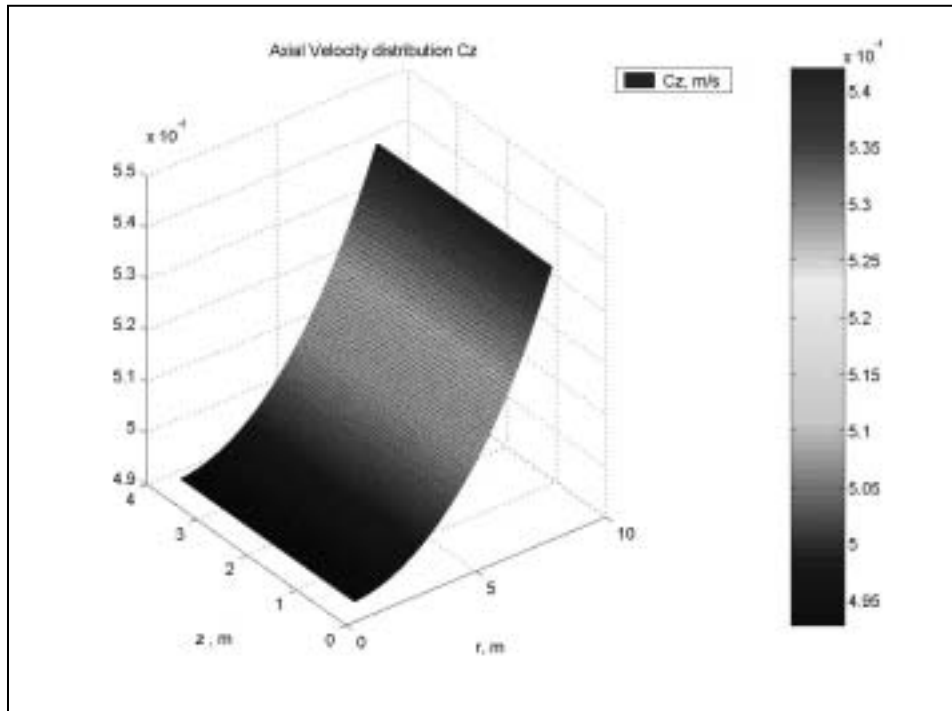

Figure 5. Radial velocity distribution, $Q = Q_{max}$, 3 operating strainers

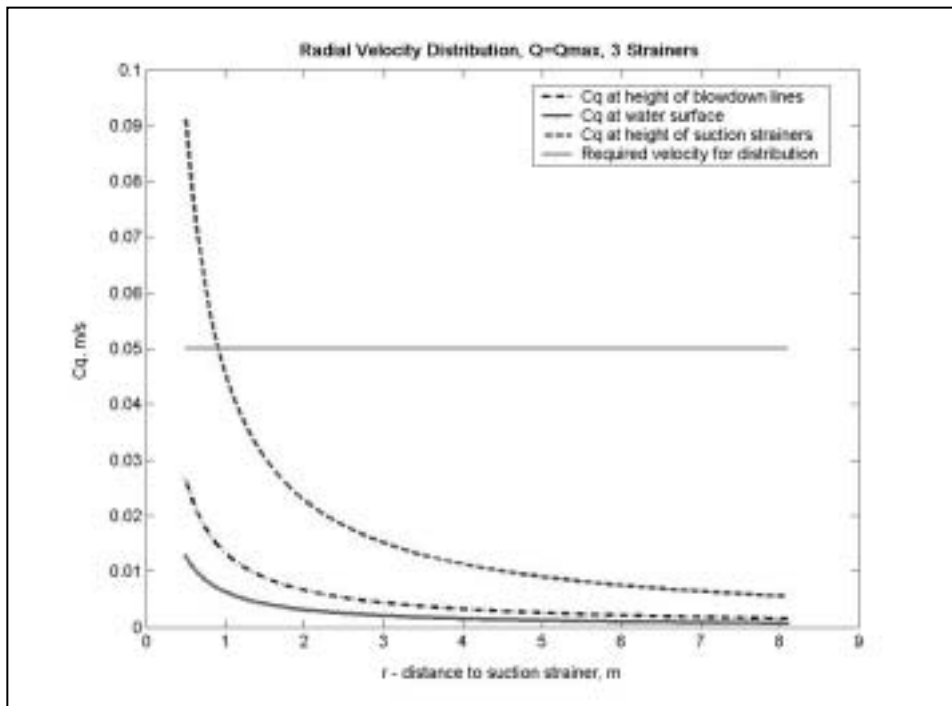

Figure 6. Radial velocity distribution, $Q = Q_{min}$, 1 strainer

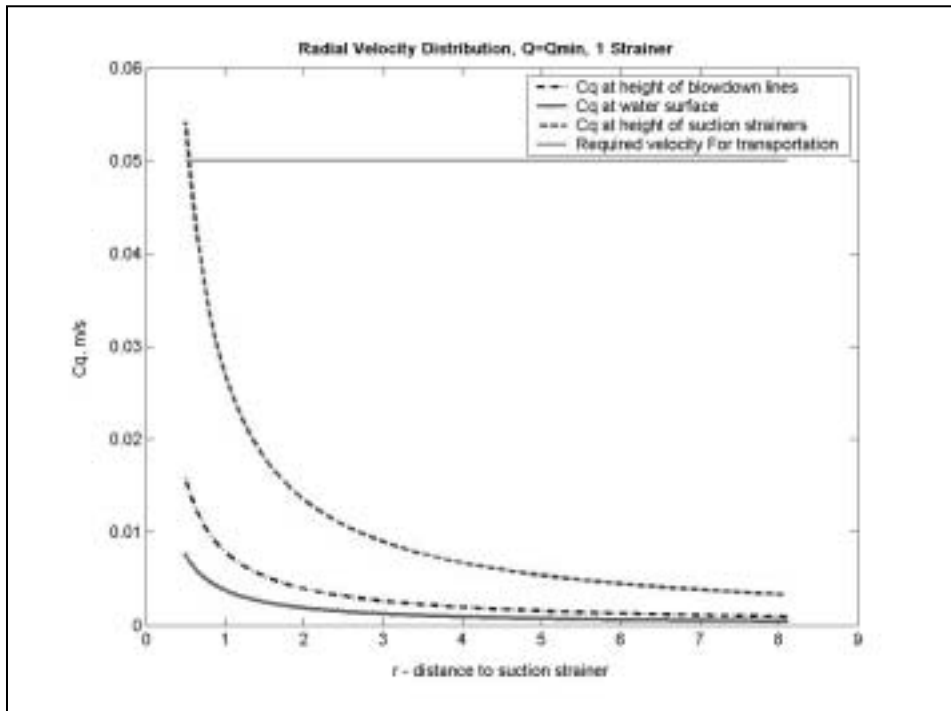
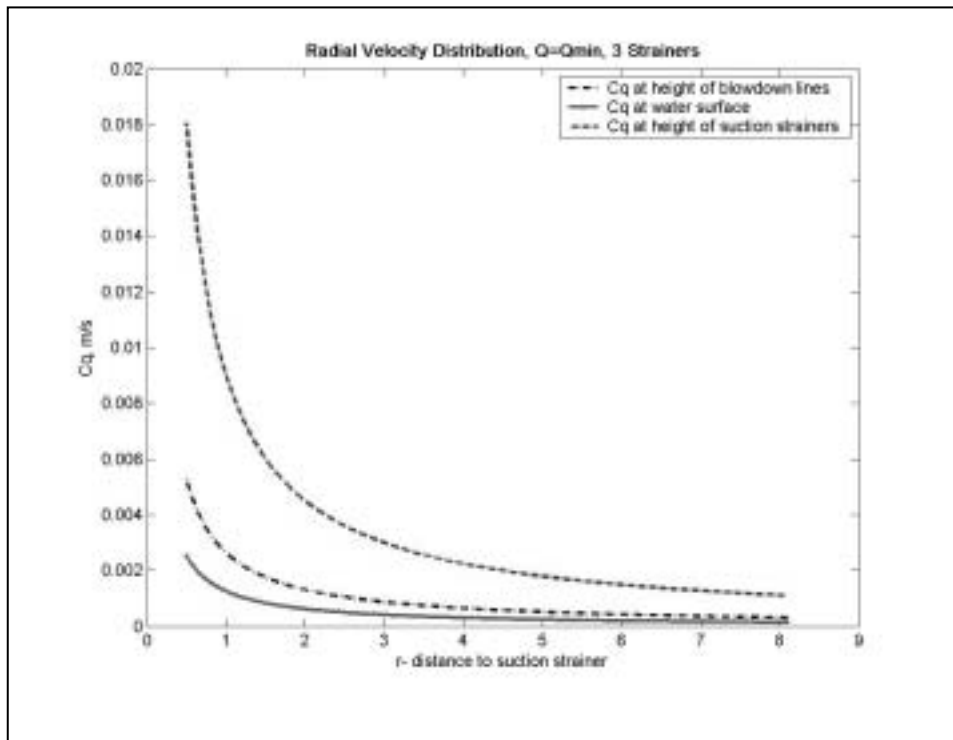

Figure 7. Radial velocity distribution, $Q = Q_{min}$, 3 strainers



LIST OF PARTICIPANTS

BELGIUM

DELALLEAU, Jean-Charles (Mr.)
Nuclear Safety Engineer
Electrabel
Avenue De l'Industrie, 1
B-4500 Tihange

Phone: +32 8 524 39 66
Fax: +32 8 524 39 79
E-mail: jeancharles.delalleau@electrabel.com

DELVEAU, Caroline (Ms.)
Industrial Engineer
Tractebel Engineering
Avenue Ariane, 7
B-1200 Brussels

Phone: +32 2 773 97 24
Fax: +32 2 773 89 00
E-mail: caroline.delveau@tractebel.com

DU BOIS D'ENGHIEN, Guillaume
Tractebel Engineering
Avenue Ariane, 7
B-1200 Brussels

Phone: +32 2 773 08 47
Fax : +32 2 773 89 00
E-mail:
guillaume.duboisd'enghien@tractebel.com

GAUTHIER, Phillipe, (Mr.)
Westinghouse Energy Belgium S.A.
Rue de l'Industrie, 43
B-1400 Nivelles

Phone: +32 6 728 82 32
Fax: +32 6 728 83 32
E-mail: gauthier-ph@notes.westinghouse.com

TOMBUYSES, Beatrice (Dr.)
System Engineer
Association Vinçotte Nuclear (AVN)
Rue Walcourt, 148
B-1070 Brussels

Phone: +32 2 528 02 61
Fax: +32 2 528 01 02
E-mail: bto@avn.be

VANDEWALLE, André (Dr.)
Division Head
Inspections of Nuclear Installations
Association Vinçotte Nuclear (AVN)
Rue Walcourt, 148
B-1070 Brussels

Phone: +32 2 528 01 30
Fax: +32 2 528 01 01
E-mail: avw@avn.be

CANADA

EYVINDSON, Ailsa (Ms.)
R&D Engineer
Atomic Energy of Canada Limited
Chalk River Laboratories
Chalk River, Ontario, K0J 1J0

Phone: +1 613 584-8811 ext 4593
Fax : +1 613 584-8216
E-mail: eyvindsona@aecl.ca

RHODES, David (Mr.)
Manager,
Mechanical Equipment and Seal Development
Atomic Energy of Canada Limited
Chalk River Laboratories
Chalk River, Ontario, K0J 1J0

Phone: +1 613 584-8811 ext. 3733
Fax: +1 613 584-8216
E-mail: rhodesd@aecl.ca

CZECH REPUBLIC

KUJAL, Bohumir (Dr.)
Senior Consultant
Nuclear Research Institute Rez, plc
250 68 Rez

Phone: +420 266 173 657
Fax: +420 266 173 570
E-mail: kub@ujv.cz
bohumer.kujal@ujv.cz

VESELY, Jiri (Mr.)
Head of Local Inspectors, NPP Dukovany
State Office for Nuclear Safety
Senovazne nam.9 Prague

Phone: +420 568 815 552
Fax: +420 568 866 414
E-mail: jiri.vesely@subj.cz

FINLAND

PAALANEN, Anssi (Mr.)
Nuclear Safety Engineer
Teollisuuden Voima Oy
FIN-27160 Olkiluoto

Phone: +358 2 8381 3233
Fax: +358 2 8381 3209
E-mail: anssi.paalanen@tvo.fi

SJOVALL, Heikki (Mr.)
Teollisuuden Voima Oy
FIN-27160 Olkiluoto

Phone: +358 2 8381 3222
Fax: +358 2 8381 3209
E-mail: Heikki.Sjovall@tvo.fi

FRANCE

ARMAND, Yves (Dr.)
Project Manager
Service d'Évaluation des Risques et des Systèmes
Département d'Évaluation de Sûreté
Institut de Radioprotection et de Sûreté Nucléaire
(IRSN), B.P. 17
F-92262 Fontenay-aux-Roses Cedex

Phone: +33 1 58 35 82 07
Fax: +33 1 58 35 89 89
E-mail: yves.armand@irsn.fr

BLOMART, Philippe (Mr.)
Senior Engineer
EDF
12-14 Avenue Dutrievoz
F-69628 Villeurbanne Cedex

Phone: +33 4 72 82 71 52
Fax: +33 4 72 82 77 02
E-mail: philippe.blomart@edf.fr

COLIN, Pierre (Mr.)
Fluid System Engineer
Framatome ANP
Tour Areva
F-92084 Paris La Défense

Phone: +33 1 47 96 32 94
Fax: +33 1 47 96 31 88
E-mail: pierre.colin@framatome-anp.com

DURIN, Michel (Dr.)
Deputy Head, Reactor Safety Direction
Institut de Radioprotection et de Sûreté Nucléaire
(IRSN), B.P. 17
F-92262 Fontenay-aux-Roses Cedex

Phone: +33 1 58 35 81 83
Fax : +33 1 46 54 32 64
E-mail: michel.durin@irsn.fr

DESCHILDRE, Olivier (Mr.)
Direction Générale de la Sûreté Nucléaire et de la
Radioprotection (DGSNR)
10 Route du Panorama
F-92266 Fontenay-aux-Roses Cedex

Phone: +33 1 43 19 70 60
Fax: +33 1 43 19 70 66
E-mail: olivier.deschildre@asn.minefi.gouv.fr

GORBATCHEV, Alexandre (Mr.)
Institut de Radioprotection et de Sûreté Nucléaire
(IRSN)
B.P. 17
F-92262 Fontenay-aux-Roses Cedex

Phone: +33 1 58 35 71 02
Fax: +33 1 58 35 86 54
E-mail: alexandre.gorbachev@irsn.fr

MATTEI, Jean-Marie (Mr.)
Chef de Service
Service d'Évaluation des Risques et des Systèmes
Département d'Évaluation de Sûreté
Institut de Radioprotection et de Sûreté Nucléaire
(IRSN)
B.P. 17
F-92262 Fontenay-aux-Roses Cedex

Phone: +33 1 58 35 82 99
Fax: +33 1 58 35 89 89
E-mail: jean-marie.mattei@irsn.fr

PARADIS, Luc (Mr.)
Safety Projects Engineer
CEA
Commissariat à l'Énergie Atomique
Centre de Saclay
F-91191 Gif-sur-Yvette Cedex

Phone: +33 1 69 08 25 00
Fax: +33 1 69 08 58 70
E-mail: luc.paradis@cea.fr

ROYEN, Jacques (Mr.)
Nuclear Safety Division
OECD Nuclear Energy Agency
Le Seine Saint-Germain
12 Boulevard des Iles
F-92130 Issy-les-Moulineaux

Phone: +33 1 45 24 10 52
Fax: +33 1 45 24 11 29
E-mail: jacques.royen@oecd.org
royen@nea.fr

VIAL, Eric (Mr.)
Branch Manager
IRSN
77-83 avenue du Général-de-Gaulle
F-92140 Clamart

Phone: + 33-1-58-35-80-19
Fax: + 33-1-58-35-89-89
E-mail: eric.vial@irsn.fr

WALTER, Stephane (Mr.)
Engineer
ECCS
EDF-CIPN 140 Avenue VITON
F-13401 Marseille

Phone: +33 491 74 9283
Fax: +33 491 74 9538
E-mail: stephane.walter@edf.fr

GERMANY

ALT, Soeren (Mr.)
University of Applied Sciences Zittau/Goerlitz
Theodor-Koerner-Allee 16
D-02763 Zittau

Phone: +49 3583 611544
Fax: +49 3583 611288
E-mail: s.alt@hs-zigr.de

BRAUN, Gerhard (Mr.)
Hessian Ministry for Environment
Verbraucherschutz, Mainzer Strasse 80
D-65021 Wiesbaden

Phone: +01149 0611-815-1556
Fax: +01149 0611 815 1945
E-mail: g.braun@hmulv.hessen.de

HUBER, Josef (Mr.)
TÜV Süddeutschland Bau und Betrieb GmbH
Abteilung ETA 1
Westendstrasse 199
D-80686 München

Phone: +49 89 5791 1285
Fax: +49 89 5791 2696
E-mail: josef.huber@tuev-sued.de

KAESTNER, Wolfgang (Dr.)
Research Engineer
University of Applied Sc. Zittau/Goerlitz (FH)
Theodor-Koerner-Allee 16
D-02763 Zittau

Phone: +49 3583 611553
Fax: +49 3583 611288
E-mail: w.kaestner@hs-zigr.de

KNITT, Ulrich (Mr.)
Safety analysis
RWE Power AG
Huysenallee 2
D-45128 Essen

Phone: +49 201 122 2282
Fax: +49 201 122 1948
E-mail: Ulrich.knitt@rwe.com

KREPPER, Eckhard (Dr.)
Forschungszentrum Rossendorf e.V.
Institute of Safety Research
POB 510119
D-01314 Dresden

Phone: +49 351 260 2067
Fax: +49 351 260 2383
E-mail: e.krepper@fz-rossendorf.de

MAQUA, Michael (Dr.)
Assistant to the Scientific Director
Gesellschaft für Anlagen- und Reaktorsicherheit
(GRS) mbH
Schwertnergasse 1
D-50667 Köln

Phone: +49 221 2068 718
Fax: +49 221 2068 704
E-mail: maq@grs.de

OHLMEYER, Hermann (Mr.)
Head Section Reactor Safety
Hamburgische Electricitätswerke AG
Ueberseering 12
D-22297 Hamburg

Phone: +49 406 396 3701
Fax: +49 406 396 3004
E-mail: hermann.ohlmeyer@hew.de

PÜETTER, Bernhard (Dr.-Ing)
Group Leader, Accident Management
Thermal-Hydraulics & Process Eng. Div.
Gesellschaft für Anlagen- und Reaktorsicherheit
(GRS) mbH
Schwertnergasse 1,
D-50667 Köln

Phone: +49 221 2068 681
Fax: +49 221 2068 834
E-mail: pue@grs.de

SCHAFFRATH, Andreas (Dr.)
Section Head
Safety & Accident Analysis,
Technischer-Überwachungsverein Nord e.V.
Bereich Energie-und Systemtechnik
D-22525 Hamburg

Phone: +49 (40) 8557 2963
Fax: +49 (40) 8557 1901 7413
E-mail: aschaffrath@tuev-nord.de

SEEBERGER, Gerd Joachim (Mr.)
Senior Expert, Safety Engineering
Framatome ANP GmbH
POB 3220
D-91050 Erlangen

Phone: +49 9131 1892124
Fax: +49 9131 1894345
E-mail:

SEELIGER, Andre (Mr.)
University of Applied Sciences Zittau Goerlitz
Theodor-Koerner-Allee 16
D-02763 Zittau

Phone: +49 3583 6115 44
Fax: +49 3583 611288
E-mail: aseeliger@hs-zigr.de

TIETSCH, Wolfgang (Dr.)
Westinghouse Electric Germany
Dudenstrasse 44
D-68161 Mannheim

Phone: +49 621 388 2120
E-mail:
wolfgang.tietsch@de.westinghouse.com

WAAS, Ulrich (Mr.)
Senior Expert
c/o Framatome-ANP GmbH
NGPS
Postfach 3220
D-91050 Erlangen

Phone: +49 9131 1894 730
Fax: +49 9131 1894 787
E-mail: ulrich.waas@framatome-anp.com

WASSILEW-REUL, Christine (Ms.)
Referentin
Nuclear Safety
Robert-Schumann-Platz 3
D-53175 Bonn

Phone: +49 01888-305 2858
Fax: +49 01888-305 3963
E-mail: Christine.wassilew-reul@bmu.bund.de

JAPAN

ISHIKAWA, Masao (Mr.)
Senior Researcher & Senior Officer
Safety Information Analysis Group
Safety Intelligence Division
Japan Nuclear Energy Safety Org. (JNES)
Fujita Kanko Toranomom Bldg.
3-17-1, Toranomom, Minato-ku
Tokyo 105-0001

Phone: +81 3 4511-1932
Fax: +81 3 4511-1998
E-mail: ishikawa-masaaki@jnes.go.jp

MATSUOKA, Hiroshi (Mr.)
Mitsubishi Heavy Industries, Ltd.
1-1, Wadasaki-cho 1-chome, Hyogo-ku
Kobe, 652-8585

Phone: +81 78 672-3342
Fax: +81 78 672-3349
E-mail: hiroshi_matsuoka@mhi.co.jp

NAKAMURA, Hideo (Dr.)
Head of Laboratory
Japan Atomic Energy Research Inst. (JAERI)
2-4, Shirakata Shirane
Tokai-mura, Ibaraki-ken 319-1195

Phone: +81 29 282 5263
Fax: +81 29 282 6728
E-mail: nakam@lstf3.tokai.jaeri.go.jp

SHIRAYANAGI, Harunobu (Mr.)
Tokyo Electric Power
1-1-3, Uchisaiwai-cho, Chiyoda City
Tokyo Met.

Phone: +81 3 4216 4804
Fax : +81 3 596 8540
E-mail: shirayanagi.hal@tepcoco.jp

TANAKA, Toshihiko (Mr.) (Tosi)
Manager, Nuclear Engineer
Kansai Electric Power Co., Inc.
3-3-22 Nakanoshima Kita-ku
Osaka

Phone: +81 6 6441 8821
Fax: +81 6 6441 4277
E-mail: k410924@kepcoco.jp

MEXICO

MAMANI ALEGRIA, Yuri Raul (Mr.)
Technical Consultant
National Commission on Nuclear Safety and
Safeguards (CNSNS)
Dr. Barragan 779
03020 Distrito Federal

Phone: +52 55 5095 3235
Fax: +52 55 5095 3293
E-mail: yrmamani@cnsns.gob.mx

NETHERLANDS

HUIBREGTSE, Piet (Mr.)
Senior Engineer Evaluations
NV EPZ (NPP Borssele)
P.O. Box 130
NL-4380 AC Vlissingen

Phone: +31 113 356370
Fax: +31 113 352434
E-mail: p.huibregtse@epz.nl

ROOSEBOOM, Arend J. (Mr.)
Nuclear Safety Inspector
Nuclear Safety Dept (KFD), VROM Ministry
P.O. Box 16191
NL-2500 BD The Hague

Phone: +31 70 339 21 84
Fax: +31 70 339 18 87
E-mail: arend.rooseboom@minvrom.nl

SPAIN

ALONSO-ESCÓS, José R. (Mr.)
Division Manager (Nuclear Systems)
Consejo de Seguridad Nuclear (CSN)
Justo Dorado, 11
SP-28040 Madrid

Phone: +34 91 346 0207
Fax: +34 91 346 0216
E-mail: jrae@csn.es

ALONSO-LÓPEZ, Mónica (Ms.)
Nuclear System Specialist
Consejo de Seguridad Nuclear (CSN)
Justo Dorado, 11
SP-28040 Madrid

Phone: +34 91 346 0663
Fax: +34 91 346 0216
E-mail: mal@csn.es

SORIANO, Luis
Manager
Almara-Trillo NPP's
Carlos Trias Bertran, 7
SP-28020 Madrid

Phone: +34 619 748 134
Fax: +34 915 566 520
E-mail: l.soriano@cnat.es

TARRASA BLANES, Fernando (Mr.)
Systems Engineer, ANAV
Vandellos II Nuclear Power Plant
P.O. Box 27
SP-43890 L'Hospitalet de L'Infant

Phone: +34 977 81 87 00
Fax: +34 977 81 00 14
E-mail: ftarrasa@anacnv.com

VILLALBA-DOMINGUEZ, Cristina (Ms.)
Nuclear System Expert
Consejo de Seguridad Nuclear (CSN)
Justo Dorado, 11
SP-28040 Madrid

Phone: +34 91 346 0269
Fax: +34 91 346 0216
E-mail: cvd@csn.es

SLOVAK REPUBLIC

BATALIK, Jozef (Mr.)
Assistant to the Director
VUEZ a.s. Levice
Hviezdoslavova 35, P.O. Box 153
Levice

Phone: +421 366 35 5311
Fax: +421 366 35 5313
E-mail: batalik@vuez.sk

VICENA, Ivan (Mr.)
Senior designer
VUEZ a.s. Levice
Hviezdoslavova 35, P.O. Box 153
Levice

Phone: +421 366 355 336
Fax: +421 366 355 313
E-mail: vicena@vuez.sk

SLOVENIA

BASIC, Ivica (Mr.)
Lead Analysis Engineer
Nuclear Power Plant Krsko
NPP Krsko, Vrbina 12
8270 Krsko

Phone: +38 674 802 527
Fax: +38 674 921 528
E-mail: ivica.basic@nek.si

SWEDEN

HENRIKSSON, Mats E. (Mr.)
Vice-President
Corporate Senior Scientist
Vattenfall Utveckling AB
SE-814 26 Älvkarleby

Phone: +46 26 835 40
Fax: +46 26 836 70
Mobile: +46 70 520 95 30
E-mail: mats.henriksson@vattenfall.com

RINGDAHL, Kjell (Mr.)
Technical Support Ringhals Unit 3
Ringhals AB
SE-430 22 Väröbacka

Phone: +46 340 6685273
Fax: +46 340 667304
E-mail: kjell.ringdahl@ringhals.se

SANDERVAG, Oddbjörn (Mr.)
Reactor Safety Research Coordinator
Swedish Nuclear Power Inspectorate (SKI)
Klarabergsviadukten 90
SE-106 58 Stockholm

Phone: +46 8 698 84 63
Fax: +46 8 661 90 86
E-mail: oddbjorn.sandervag@ski.se

SIVULA, Mikael (Mr.)
Project Manager
Ringhals AB
SE-430 22 Väröbacka

Phone: +46 340 667585
Fax: +46 340 668851
E-mail: mikael.sivula@ringhals.se

SWITZERLAND

BLUMER, Urs Richard (Dr.)
Manager NS, Nuclear Engineering
CCI AG, IM Link 11
CH-8404 Winterthur

Phone: +41 52 264 9556
Fax: +41 52 264 9550
E-mail: urs.blumer@ccivalve.ch

ELVERT, Peter-Jens (Mr.)
Sales Engineer
CCI AG, IM Link 11
P.O. Box 65
CH-8404 Winterthur

Phone: + 41 52 264 9548
Fax: +41 52 264 9550
E-mail: peter-jens.elvert@ccivalve.ch

KLÜGEL, Jens-Uwe (Dr.)
Technical Adviser
Kernkraftwerk Goesgen
Kraftwerkstrasse
CH-4658 Daeniken

Phone: +41 62 288 2077
Fax: +41 62 288 2001
E-mail: jkluegel@kkg.ch

UNITED STATE OF AMERICA

ABDEL-FATTAH, Amr
Staff Member, Colloid & Containment Trans.
Los Alamos National Laboratory
PO Box 1663, MS J514
Los Alamos, NM 87545

Phone: +1 505 665-2339
Fax: +1 505 665-4955
E-mail: amr2450@lanl.gov

ANDREYCHEK, Timothy (Mr.)
Principal Engineer
Westinghouse Electric Company
4350 Northern Pike
Monroeville, PA

Phone: +1 412 374-6246
Fax: +1 412 374-5099
E-mail: andreysts@westinghouse.com

ARCHITZEL, Ralph (Mr.)
Senior Reactor Engineer
US Nuclear Regulatory Commission
Mail Stop One 11-A11
Washington, DC 20555-0001

Phone: +1 301 415-2804
Fax: +1 301 415-2300
E-mail: rea@nrc.gov

ASHBAUGH, Scott (Mr.)
Program Coordinator, Energy & Env. Progr.
Los Alamos National Laboratory
P.O. Box 1663, MS F606
Los Alamos, NM 87545

Phone: +1 505 664-0548
Fax: +1 505 665-5204
E-mail: sga@lanl.gov

BADEWITZ, Marty (Mr.)
Project Manager
Dominion Virginia Power
5000 Dominion Blvd.
Glen Allen, VA 23060

Phone: +1 804 273-2711
Fax: +1 804 273-3448
E-mail: marty_badewitz@dom.com

BAGNAL, Charles (Mr.)
Power Sales Manager, Nuclear Engineering
General Electric
3901 Castle Wayne Road
Wilmington, NC

Phone: +1 910 675-6785
Fax:
E-mail: charles.bagnal@gene.ge.com

BAHADUR, Sher (Dr.)
Deputy Director
Div. of Systems Analysis & Reg. Effectiveness
(DSARE), Office of Nuclear Reg. Research
US Nuclear Regulatory Commission
Mail Stop T-10 E29
Washington, DC 20555

Phone: +1 301 415-7499
Fax: +1 301 415-5160
E-mail: sxb@nrc.gov

BECK, Deane (Mr.)
Marketing Manager
Control Components, Inc.
22591 Avenida Empresa
Ranch Santa Margarita, CA 92688

Phone: +1 949 858-1878
Fax: +1 949 858-1878
E-mail: dbeck@ccivalve.com

BILANIN, Alan (Mr.)
Continuum Dynamics
34 Lexington Ave.
Ewing, NJ

Phone: +1 609 538-0444
Fax: +1 609 538-0464
E-mail: bilanin@continuum-dynamics.com

BLEIGH, James (Mr.)
Engineered Systems Manager
Performance Contracting, INC
4025 Bonner Industrial Drive
Shawnee, KS 66226

Phone: +1 913 441-0100
Fax: +1 913 441-0953
E-mail: jim.bleigh@pcg.com

BOSTELMAN, Janice (Ms)
Science Advisor
Alion Science & Technology
6000 Uptown Blvd., Suite 300
Albuquerque, NM

Phone: +1 505 872-1089
Fax: +1 505 872-0233
E-mail: jbstelman@alionscience.com

BRANDES, Matt (Mr.)
Design Engineer, Ameren UE
Callaway Plant
Jct CC & Hwy O
P.O. Box 620
Fulton, MO 65251

Phone: +1 573 676-8953
Fax: +1 573 676-4334
E-mail: mdbrandes@cal.ameren.com

BRYAN, Robert H. (Mr.)
Sr. Nuclear Specialist
Tennessee Valley Authority
1101 Market Street
Chattanooga, TN 37402

Phone: +1 423 751-8201
Fax: +1 423 751-7084
E-mail: rhbryan@tva.gov

BRYAN, Robert (Mr.)
Director, Atlanta Operations
Enercon Services, Inc.
500 Town Park Lane, Suite 275
Kennesaw, GA 30144

Phone: +1 770 919-1931, Ext. 222
Fax: +1 770 919-1932
E-mail: rbryan@enercon.com

BUTLER, John (Mr.)
Senior Project Manager
Nuclear Energy Institute
1776 I St. NW
Washington DC 20006

Phone: +1 202 739-8108
E-mail: jcb@nei.org

BUTNER, Nancy (Ms.)
Project Manager
Los Alamos National Laboratory
P.O. Box 1663, MS K557
Los Alamos, NM 87544

Phone: +1 505 667-8016
Fax: +1 505 667-5531
E-mail: nbutner@lanl.gov

CAIN, Stuart (Dr.)
Vice-President
Alden Research Laboratory, Inc.
30 Shrewsbury Street
Holden, MA 01520

Phone: +1 508 829-6000 ext. 439
Fax: +1 508 829-2795
E-mail: sacain@aldenlab.com

CARUSO, Ralph (Mr.)
Senior Staff Engineer
Advisory Committee on Reactor Safeguards
(ACRS)
US Nuclear Regulatory Commission
MS-T2E26
Washington, DC 20555-0001

Phone: +1 301 415-8065
Fax:
E-mail: rxc@nrc.gov

CAVALLO, Jon R. (Mr.)
Vice President
CCC & L, Inc.
P.O. Box 226
Eliot, ME 03903

Phone: +1 603 431-1919
Fax: +1 603 431-2540
E-mail: jrcpe@aol.com

CHANG, Tsun-Yung (Mr.)
Senior Project Manager
US Nuclear Regulatory Commission
11545 Rockville Pike
Rockville, MD 20852

Phone: +1 301 415-6450
Fax: +1 301 415-5074
E-mail : tyc@nrc.gov

<p>CHOROMOKOS, Robert (Mr.) Project Manager Alion Science & Technology 6000 Uptown Blvd. NE, Suite 300 Albuquerque, NM</p>	<p>Phone: +1 630 846-6787 Fax: E-mail: rchoromokos@alionscience.com</p>
<p>CORLEY, Clay (Mr.) System Engineer TXU Comanche Peak P.O. Box 1002 Glen Rose TX 76043</p>	<p>Phone: +1 254 897-5904 Fax: +1 254 897-0972 E-mail: claycorley@txu.com</p>
<p>CSONTOS, Aladar (Dr.) (Al) Materials Engineer US Nuclear Regulatory Commission Office of Nuclear Materials Safety & Safeguards MS T-7 F-3 Washington, DC 20555-0001</p>	<p>Phone: +1 301 415-6352 Fax: +1 301 415-5397 E-mail: aac@nrc.gov</p>
<p>CULLEN, Bill (Mr.) Sr. Materials Engineer US Nuclear Regulatory Commission MS T10 E-10 Washington, D.C. 20555</p>	<p>Phone: +1 301-415-7510 Fax: +1 301 415-5074 E-mail: whc@nrc.gov</p>
<p>DENNING, Richard S. (Rich) (Dr.) Sr. Research Leader Battelle 505 King Ave. Columbus, OH</p>	<p>Phone: +1 614 424-7412 Fax: +1 614 424-3404 E-mail: denning@battelle.org</p>
<p>DING, Mei (Dr.) TSM – Environmental Chemistry Los Alamos National Laboratory C-INC, MS J514 Los Alamos, NM 87545</p>	<p>Phone: +1 505 667-7051 Fax: +1 505 665-4955 E-mail: mding@lanl.gov</p>
<p>DRAKE, Andre (Mr.) Senior Engineer Constellation Energy Group Calvert Cliffs Nuclear Power Plant Lusby, MD 20657</p>	<p>Phone: +1 410 495-3932 Fax: +1 410 495-3944 E-mail: andre.s.drake@ceg.com</p>
<p>ELLIOTT, Robert (Mr.) (Rob) Technical Assistant US Nuclear Regulatory Commission MS 0-10A1 Washington, DC 20555</p>	<p>Phone: +1 301 415-1397 Fax: +1 301 415 3577 E-mail: rbe@nrc.gov</p>

EVANS, Michele (Ms.)
Branch Chief
US Nuclear Regulatory Commission
11545 Rockville Pike
Rockville, MD 20852-2738

Phone: +1 301 415-7210
Fax: +1 310 415-5074
E-mail: mge@nrc.gov

FEIST, Charles (Mr.)
Consulting Mechanical Engineer
TXU Energy
P.O. Box 1002
Glen Rose, TX 76043

Phone: +1 254 897-8605
Fax: +1 254 897-0530
E-mail: cfeist1@txu.com

FISCHER, Stewart (Dr.)
Team Leader/Nuclear Reactor Safety
Los Alamos National Laboratory
P.O. Box 1663 MS K557
Los Alamos, NM 87545

Phone: +1 505 665-3395
Fax: +1 505 667-5531
E-mail: sfischer@lanl.gov

FRIEDMAN, Michael (Mr.)
ECCS Strainer Project Manager
OPPD
Fort Calhoun Nuclear Station,
MS FC-2-4 ADM
Fort Calhoun, NE

Phone: +1 402 533-7341
Fax: +1 402 533-7390
E-mail: mjfriedman@oppd.com

GARCIA, Jeanette (Ms.)
Student Research Assistant
University of New Mexico
7905 Puritan Ct. NE
Albuquerque, NM 87109

Phone: +1 505 610-4410
Fax:
E-mail: janet_j_Garcia@yahoo.com

GARCIA-SERAFIN, Jose (Mr.)
Chief Nuclear Engineer
Florida Power & Light
700 Universe Boulevard
Juno Beach, FL

Phone: +1 561 694-3371
Fax: +1 561 694-4310
E-mail: jose_garcia@fpl.com

GARTLAND, Fariba (Ms.)
Project Manager, Plant Engineering
Framatome ANP
400 South Tyron St., Suite 2100
Charlotte NC 28285

Phone: +1 704 805-2288
Fax: +1 7-4 805-2650
E-mail: fariba.gartland@framatome-anp.com

GISCLON, John (Mr.)
Nuclear Engineering Consultant
EPRI
P.O. Box 1256
Ashland, OR 97520

Phone: +1 541 488-6928
Fax:
E-mail: jogisclo@epri.com

GOLLA, Joe (Mr.)
Systems Engineer, Plant Systems
US Nuclear Regulatory Commission
15555 Rockville Pike
Rockville, MD

Phone: +1 301 415-1002
Fax: +1 301 415-2300
E-mail: jag2@nrc.gov

HAMEL, Jeffrey (Mr.)
Product Manager
General Electric
175 Curtner Avenue
m/c 755
San Jose, California 95125

Phone: +1 408 925-2747
Fax: +1 408 925-5053
E-mail: jeffrey.hamel@gene.ge.com

HAMMER, Charles G. (Mr.)
Mechanical Engineer
US Nuclear Regulatory Commission
11545 Rockville Pike
Rockville, MD 20852-2738

Phone: +1 301 415-2791
Fax: +1 301 415-2444
E-mail: cgh@nrc.gov

HANNON, John (Mr.)
Branch Chief
DSSA/NRR
US Nuclear Regulatory Commission
MS O-11A11
Washington, DC 20555

Phone: +1 301-415-1992
Fax: +1 301 415-2300
E-mail: jnh@nrc.gov

HARRINGTON, Craig (Mr.)
Consulting Engineer
TXU Energy
P.O. Box 1002
Glen Rose, TX 76043

Phone: +1 254 897-6705
Fax: +1 254 897-0530
E-mail: charrin1@txu.com

HART, Gordon (Mr.)
Insulation Strainer Design
Performance Contracting, Inc.
11662 Fall Creek Road
Indianapolis, IN 46256

Phone: +1 317 578-3990
Fax: +1 317 578-2094
E-mail: Gordon.hart@pcg.com

HERMANN, Tim (Mr.)
Supervising Engineer
Ameren UE, Callaway Plant
Jct CC & Hwy O
P.O. Box 620
Fulton, MO 65251

Phone: +1 573 676-8494
Fax: +1 573 676-4334
E-mail: tdhermann@cal.ameren.com

HOLLOWAY, Ronald (Mr.)
Project Engineer
Wolf Creek Nuclear Operation Corporation
P.O. Box 411
Burlington, KS 66839

Phone: +1 620 364-4108
Fax: +1 620 364-4154
E-mail: rohollo@wcnoc.com

HOWE, Kerry J. (Dr.)
Department of Civil Engineering
MSC01 1070
University of New Mexico
Albuquerque, NM 87131-0001

Phone: +1 505 277-2702
Fax: +1 505 277-1988
E-mail: howe@unm.edu

HSIA, Anthony (Mr.)
Office of Nuclear Regulatory Research
US Nuclear Regulatory Commission
Washington, DC 20555-0001

Phone: +1 301 415-6933
Fax : +1 301 415-5074
E-mail: ahh@nrc.gov

JACKSON, Christopher (Mr.)
Technical Assistant
US Nuclear Regulatory Commission
One White Flint North
11555 Rockville, Maryland 20852 USA

Phone: +1 301 415-1750
Fax: +1 301 415-1757
E-mail: cpj@nrc.gov

JOHNSON, Michael (Mr.)
Deputy Division Director
System Safety & Analysis
US Nuclear Regulatory Commission
Mail Stop O-10A1
Washington, DC 20555

Phone: +1 301 415-3226
Fax: +1 301 415-3577
E-mail: MRJ1@nrc.gov

KEMPER, William (Mr.)
OIG Technical Advisor
US Nuclear Regulatory Commission
Mail Stop T5 D28
Washington, DC 20555-0001

Phone: +1 301 415-5974
E-mail: wek@nrc.gov

KHAN, Saif (Mr.)
Project Manager
Energy Operations, Inc.
1448 SR 333
Russellville, AR 72802-0967

Phone: +1 479 858-4941
E-mail: skhan@entergy.com

KISHIOKA, Kazuhiko (Mr.)
Japan Atomic Power Co. Representative
Japan Electric Power Info Center
1120 Connecticut Ave. NW Suite 1070
Washington, DC 20036

Phone: +1 202-955-5610
Fax: +1 202-955-5612
E-mail: genden@jepic.com

KOWAL, Mark (Mr.)
Reactor Systems Engineer
US Nuclear Regulatory Commission
11555 Rockville Pike
Rockville, MD 20852

Phone: +1 301 415-1663
E-mail: mxk7@nrc.gov

KRESS, Tom (Dr.)
ACRS Member
102B Newridge Road
Oak Ridge, Tennessee 37830

Phone: +1 865 483-7548
Fax: +1 865 482-7458
E-mail: tskress@aol.com

LAVRETTA, Maria Angeles (Ms.)
Reactor Systems Engineer
US Nuclear Regulatory Commission
Washington, DC 20555

Phone: +1 310 415-3285
Fax: +1 301 415-2300
E-mail: AXL3@nrc.gov

LEONARD, Mark (Mr.)
Dycoda, LLC
267 Los Lentos Rd.
Los Lunas, NM 87031

Phone: +1 505 866-4800
Fax: +1 505 866-4801
E-mail: mtl@dycoda.com

LETELLIER, Bruce C. (Dr.)
Los Alamos National Laboratory
D-5 Nuclear Design and Risk Analysis
P.O. Box 1663, Mail Stop K557
Los Alamos, NM 87545

Phone: +1 505 665-5188
Fax: +1 505 667-5531
E-mail: bcl@lanl.gov

LINCOLN, Donald (Mr.)
Director, Commercial Utility Programs
Alion Science and Technology
6000 Uptown Blvd. NE Suite 300
Albuquerque, NM

Phone: +1 505 872-1089
Fax: +1 505 872-0233
E-mail: dlincoln@alionscience.com

LUND, Louise (Ms.)
Section Chief
US Nuclear Regulatory Commission
MS 0-9H6
Washington, DC 20555-0001

Phone: +1 301-415-3248
Fax: +1 301 415-2444
E-mail: lxl@nrc.gov

MAJI, Arup (Prof.)
Department of Civil Engineering
MSC01-1070
University of New Mexico
Albuquerque, NM 87131

Phone: +1 505 277-1757
Fax:
E-mail: amaji@unm.edu

MATHUR, Kiran (Mr.)
Senior Engineer
Public Service Electric & Gas Co.
P.O. Box 236
Hancocks Bridge NJ 08038

Phone: +1 856-339-7215
Fax: +1 856-339-1218
E-mail: kiran.mathur@pseg.com

MCCLURE, Patrick R. (Mr.)
D-5 Group Leader, Nuclear Safety
Los Alamos National Laboratory
P.O. Box 1663, MS K557
Los Alamos, NM 87545

Phone: +1 505 667-9534
Fax: +1 505 665-2897
E-mail: pmcclure@lanl.gov

MCGOUN, Wes (Mr.)
Principal Engineer
Progress Energy
410 South Wilmington St., PEB-6
Raleigh, NC

Phone: +1 919 546-2040
Fax: +1 919 546-7854
E-mail: wes.mcgoun@pgnmail.com

MCNAMARA, Joseph (Mr.)
Engineering Supervisor
Civil-Structural Design
Nuclear Management Company
Point Beach Nuclear Power Plant
6610 Nuclear Road
Two Rivers, WI 54241

Phone: +1 920 755-7421
Fax: +1 920 755-7410
E-mail: joe.mcnamara@nmcco.com

MIDLIK, David W. (Mr.)
Senior Engineer
Southern Nuclear
P.O. Box 1295-031
Birmingham, Alabama 35201

Phone: +1 205 992-6860
Fax: +1 205 992-7149
E-mail: dwmidlik@southernco.com

MYER, Chalmer (Mr.)
Engineering Supervisor, Mechanical
Southern Nuclear
40 Inverness Parkway
Birmingham, Alabama 35242

Phone: +1 205 992-6335
Fax: +1 205 992-7149
E-mail: cmyer@southernco.com

PAGE, Joel D. (Mr.)
Mechanical Engineer
USNRC
MS T10-E10
Washington, DC 20555

Phone: +1 301 415-6784
Fax: +1 301 415-5074
E-mail: jdp2@nrc.gov

PARCZEWSKI, Krzysztof (Dr.)
Senior Chemical Engineer
US Nuclear Regulatory Commission
11555 Rockville Pike
Rockville, MD 20852-2738

Phone: +1 301 415-2705
Fax: +1 301 415-2444
E-mail: kip@nrc.gov

QUITORIANO, Gregory
Design Engineer
Pacific Gas & Electric
P.O. Box 56
Avila Beach, CA

Phone: +1 805 545-4948
Fax: +1 805 545-6605
E-mail: geq1@pge.com

RAO, Dasari V. (Dr.)
Los Alamos National Laboratory
P.O. Box 1663
Los Alamos, NM 87545

Phone: +1 505 667-4567
Fax: +1 505 665-5204
E-mail: nrcdvrao@lanl.gov

RINKACS, William (Mr.)
Westinghouse Electric Co., LLC
4350 Northern Pike
Monroeville, PA

Phone: +1 412 374-4545
Fax: +1 412 374-5099
E-mail: rinkacwj@westinghouse.com

RISLEY, Bryan (Mr.)
Product/Project Manager
Transco Products Inc.
1215 East, 12th Street
Streator, IL

Phone: +1 815 672-2197
Fax: +1 815 673-2432
E-mail: bryanrisley@transcoproducts.com

RISTE, Jerry O. (Mr.)
Licensing Supervisor
Nuclear Management Co., LLC
N490 Highway 42
Kewaunee, WI 54216

Phone: +1 920 845-5022
Fax: +1 920 388-8333
E-mail: Gerald.riste@nmcco.com

SCIACCA, Frank (Mr.)
Omicron Safety and Risk Technologies
P.O. Box 93065
Albuquerque, NM 87199-3065

Phone: +1 505 883-0553
Fax: +1 505 883-0588
E-mail: fsciacca@omicron.net

SETLUR, Achyut (Dr.)
President
Automated Engineering Services Corp (AES)
3060 Ogden Ave., Suite 205
Lisle, IL

Phone: +1 630 357-8880
Fax: +1 630 357-4445
E-mail: avsetlur@aesengineering.com

SETLUR, Shashi (Ms.)
Automated Engineering Services Corp. (AES)
3060 Ogden Ave., Suite 205
Lisle, IL

Phone: +1 630 357-8880
Fax: +1 630 357-4445
E-mail: sasetlur@aesengineering.com

SHAFFER, Clinton J. (Mr.)
Principal Engineer
ARES Corporation
851 University Boulevard, SE, Suite 100
Albuquerque, NM 87106

Phone: +1 505 272-7102
Fax: +1 505 272-7238
E-mail: cshaffer@arescorporation.com

SMITH, Aaron (Mr.)
Project Manager
Enercon Services
500 TownPark Lane, Suite 275
Kennesaw, GA 30144-5509

Phone: +1 770 919-1931 x 280
Fax: +1 770 919-1932
E-mail: asmith@enercon.com

SPRING, Nancy (Ms.)
UtiliPoint International, Inc.
6000 Uptown Blvd. NE, Suite 314
Albuquerque, NM 87110

Phone: +1 505 244-7600
Fax: +1 505 244-7658
E-mail: nspring@utilipoint.com

STROSNIDER, Jack Richard Jr. (Mr.)
Deputy Director, Office of Research
US Nuclear Regulatory Commission
TWFN 10F1
Washington, DC 20555-001

Phone: +1 301 415-6045
Fax: +1 301 415-5a53
E-mail: JRS2@nrc.gov

TWACHTMAN, Gregory (Mr.)
Editor
McGraw-Hill
1200 G St. NW, Suite 1000
Washington, DC

Phone: +1 202 383-2166
Fax: +1 202 383-2187
E-mail: Gregory_twachtman@platts.com

UNIKIEWICZ, Steven (Mr.)
Engineer
US Nuclear Regulatory Commission
Mail Stop 09-D3
Washington, DC 20555-0001

Phone: +1 301 415-3819
Fax: +1 301 415-2444
E-mail: smu@nrc.gov

WALKER, John (Mr.)
Manager
Framatome ANP
400 South Tryon Street, Suite 2100, WC26A
Charlotte, NC 28285

Phone: +1 704 805-2746
Fax: +1 704 805 2650
E-mail: john.walker@framatome-anp.com

WILLIAMS, H. Lee (Mr.)
Project Development Manager
Framatome ANP
400 South Tyrone Street, Suite 2100
Charlotte, NC 28285

Phone: +1 704 805-2065
Fax: +1 704 805-2675
E-mail: lee.Williams@framatome-anp.com

WINDHAM, Terrill (Mr.)
Project Manager
Entergy-ANO
1448 S.R. 333
Russellville, AR 72802

Phone: +1 479 858-4355
Fax: +1 479 858-4496
E-mail: twindha@entergy.com

WOLBERT, Edward (Mr.)
President
Transco Products Inc.
55 E. Jackson Boulevard, Suite 2100
Chicago, IL

Phone: +1 312 427-2818
Fax: +1 312 427-4975
E-mail: edwolbert@transcoproducts.com

ZIGLER, Gilbert (Mr.)
Senior Scientist/Engineer
Alion Science and Technology
6000 Uptown Blvd. NE Suite 300
Albuquerque, NM

Phone: +1 505 872-1089
Fax: +1 505 872-0233
E-mail: gzigler@alionscience.com

FRISBEE, Rebecca (Ms.)
Los Alamos National Laboratory
P.O. Box 1663, MS P366
Los Alamos, NM 87545

Phone: +1 505 667-5543
Fax: +1 505 667-7530
E-mail: rfrisbee@lanl.gov

WEAVER, Christine (Ms.)
Los Alamos National Laboratory
P.O. Box 1663, MS P366
Los Alamos, NM 87545

Phone: +1 505 667-9436
Fax: +1 505 667-7530
E-mail: cweaver@lanl.gov

ALSO AVAILABLE

NEA Publications of General Interest

NEA News

ISSN 1605-9581

Yearly subscription: € 49 US\$ 56 £ 31 ¥ 6 600

Nuclear Energy Today (2003)

ISBN 92-64-10328-7

Price: € 21 US\$ 24 £ 14 ¥ 2 700

Nuclear Safety and Regulation

Advanced Nuclear Reactor Safety Issues and Research Needs (2002)

Workshop Proceedings, Paris, France, 18-20 February 2002

ISBN 92-64-19781-8

Price: € 75 US\$ 65 £ 46 ¥ 8 700

Nuclear Fuel Safety Criteria Technical Review (2001)

ISBN 92-64-19687-0

Price: € 20 US\$ 19 £ 12 ¥ 1 900

Collective Statement Concerning Nuclear Safety Research (2004)

Capabilities and Expertise in Support of Efficient and Effective Regulation of Nuclear Power Plants

ISBN 92-64-02169-8

Free: paper or web.

Collective Statement Concerning Nuclear Safety Research (2003)

Good Practice and Closer Criteria

ISBN 92-64-02149-3

Free: paper or web.

Nuclear Regulatory Review of Licence Self-assessment (LSA) (2003)

ISBN 92-64-02132-9

Free: paper or web.

Regulator and Industry Co-operation on Nuclear Safety Research (2003)

Challenges and Opportunities

ISBN 92-64-02126-4

Free: paper or web.

Regulatory Challenges of Decommissioning Nuclear Reactors (The) (2003)

ISBN 92-64-02120-5

Free: paper or web.

CSNI Technical Opinion Papers

No.1: Fire Probabilistic Safety Assessment for Nuclear Power Plants (2002)

No.2: Seismic Probabilistic Safety Assessment for Nuclear Facilities (2002)

ISBN 92-64-18490-2

Free: paper or web.

No.3: Recurring Events (2003)

ISBN 92-64-02155-8

Free: paper or web.

No.4: Human Reliability Analysis in Probabilistic Safety Assessment for Nuclear Power Plants (2004)

ISBN 92-64-02157-4

Free: paper or web.

No.5: Managing and Regulating Organisational Change in Nuclear Installations (2004)

ISBN 92-64-02069-1

Free: paper or web.

Direct Indicators of Nuclear Energy Efficiency and Effectiveness (2004)

Pilot Projects Results

ISBN 92-64-02061-6

Free: paper or web.

Order form on reverse side.

ORDER FORM

OECD Nuclear Energy Agency, 12 boulevard des Iles, F-92130 Issy-les-Moulineaux, France
Tel. 33 (0)1 45 24 10 15, Fax 33 (0)1 45 24 11 10 E-mail: nea@nea.fr, Internet: <http://www.nea.fr>

Qty	Title	ISBN	Price	Amount
Total*				

* Price include postage fees.

Payment enclosed (cheque or money order payable to OECD Publications).

Charge my credit card VISA Mastercard American Express

(Prices include postage and handling fees).

Card No.	Expiration date	Signature
Name		
Address		Country
Telephone	Fax	
E-mail		

Questionnaire on the quality of OECD publications

We would like to ensure that our publications meet your requirements in terms of presentation and editorial content. We would welcome your feedback and any comments you may have for improvement. Please take a few minutes to complete the following questionnaire. Answers should be given on a scale of 1 to 5 (1 = poor, 5 = excellent).

Fax or post your answer before 31 December 2004, and you will automatically be entered into the prize draw to win a year's subscription to *OECD's Observer magazine*.*

A. Presentation and layout

1. What do you think about the presentation and layout in terms of the following:

	Poor	Adequate		Excellent	
Readability (font, typeface)	1	2	3	4	5
Organisation of the book	1	2	3	4	5
Statistical tables	1	2	3	4	5
Graphs	1	2	3	4	5

B. Printing and binding

2. What do you think about the quality of the printed edition in terms of the following:

Quality of the printing	1	2	3	4	5
Quality of the paper	1	2	3	4	5
Type of binding	1	2	3	4	5
Not relevant, I am using the e-book	<input type="checkbox"/>				

3. Which delivery format do you prefer for publications in general?

Print CD E-book (PDF) via Internet Combination of formats

C. Content

4. How accurate and up to date do you consider the content of this publication to be?

1 2 3 4 5

5. Are the chapter titles, headings and subheadings...

Clear Yes No
Meaningful Yes No

6. How do you rate the written style of the publication (e.g. language, syntax, grammar)?

1 2 3 4 5

D. General

7. Do you have any additional comments you would like to add about the publication?

.....
.....
.....

Tell us who you are:

Name: E-mail:

Fax:

Which of the following describes you?

IGO NGO Self-employed Student
Academic Government official Politician Private sector

Thank you for completing the questionnaire. Please fax your answers to:

(33-1) 49 10 42 81 or mail it to the following address:

Questionnaire qualité PAC/PROD, Division des publications de l'OCDE
23, rue du Dôme – 92100 Boulogne Billancourt – France.

Title: Debris impact on Emergency Coolant Recirculation

ISBN: 92-64-00666-4 **OECD Code (printed version):** 66 2004 15 1p

* Please note: This offer is not open to OECD staff.

TABLE OF CONTENTS

FOREWORD	3
EXECUTIVE SUMMARY	9
SESSION I: SAFETY ASSESSMENT AND REGULATORY REQUIREMENTS	13
<i>Chairpersons: Dr. J.M. Mattei and Mr. J.N. Hannon</i>	
<i>Y. Armand and J.M. Mattei</i>	
Assessment on the Risk of Sump Plugging Issue on French PWR	17
<i>B. Tombuyses, P. De Gelder and A. Vandewalle</i>	
The Sump Screen Clogging Issue in Belgium from the Standpoint of the Authorized Inspection Organisation (AIO).....	29
<i>J. Huber</i>	
Conclusions Drawn from the Investigation of LOCA-Induced Insulation Debris Generation and its Impact on Emergency Core Cooling (ECC) at German NPPs – Approach Taken by/Perspective of the German TSO (TÜV)	41
<i>C. Harwood, V.Q. Tang, J. Khosla, D. Rhodes and A. Eyvindson</i>	
Uncertainties in the ECC Strainer Knowledge Base – The Canadian Regulatory Perspective	53
<i>J.N. Hannon</i>	
NRC Approach to PWR Sump Performance Resolution	63
<i>A. Hsia</i>	
Overview of US Research Related to PWR Sump Clogging	67
<i>M. Henriksson</i>	
Results of Tests with Large Sacrificial and Self-cleaning Strainers and the Installation at Ringhals 2	73
<i>Y. Armand and J.M. Mattei</i>	
Sump Plugging Risk	113
SESSION 2: EXPERIMENTAL WORK	125
<i>Chairpersons: Dr. Y. Armand and Dr. B. Letellier</i>	
<i>Y. Armand, J.M. Mattei, J. Batalik, B. Gubco, J. Murani, I. Vicena, V.N. Blinkov, M. Davydov and O.I. Melikhov</i>	
Risk of Sump Plugging – Experimental Program.....	127

<i>A. Eyvindson, D. Rhodes, P. Carson and G. Makdessi</i> Emergency Core Cooling Strainers – The CANDU Experience.....	149
<i>M. Ding, A. Abdel-Fattah, B. Letellier, P. Reimus, S. Fischer and T.Y. Chang</i> Characterisation of Latent Debris from Pressurised Water Reactor Containment Buildings.....	163
<i>C.J Shaffer, M.T. Leonard, A.K. Maji, A. Ghosh, B.C. Letellier and T.Y. Chang</i> Debris Accumulation and Head-loss Data for Evaluating the Performance of Vertical Pressurised Water Reactor Recirculation Sump Screens.....	177
<i>S. Alt, R. Hampel, W. Kaestner and A. Seeliger</i> Experimental Investigations for Fragmentation and Insulation Particle Transport Phenomena in Water Flow	193
<i>K. Howe, A.K. Maji, A. Ghosh, B.C. Letellier, R. Johns and T.Y. Chang</i> Effects of Debris Generated by Chemical Reactions on Head Loss Through Emergency Core Cooling System Strainers	209
<i>U. Waas and G.-J. Seeberger</i> Results of the Latest Large-scale Realistic Experiments Investigating the Post-LOCA Behaviour of Mineral Wool Debris in PWRs.....	217
SESSION 3: ANALYTICAL WORK	261
<i>Chairpersons: Dr. M. Maqua and Dr. T.Y. Chang</i>	
<i>J.U. Klügel</i> Simple Evaluation Model for Long Term Debris Transport Velocity in the Torus of a Mark I Containment	263
<i>E. Krepper and A. Grahn</i> Numerical Investigations for Insulation Debris Transport Phenomena in Water Flow.....	271
<i>F.W. Sciacca and D.V. Rao</i> Reassessment of Debris-Ingestion Effects on Emergency Core Cooling System Pump Performance	281
<i>A.K. Maji, D.V. Rao, B.C. Letellier, L. Bartlein, K. Ross and C.J. Shaffer</i> Separate Effects Tests to Quantify Debris Transport to the Sump Screen	301
<i>T.S. Andreychek, B.F. Maurer, D.C. Bhomick, J.F. Petsche, J. Ghergurovich, D.J. Ayres, A. Nana and J.C. Butler</i> Break Characteristic Modelling for Debris Generation Following a Design Basis Loss of Coolant Accident.....	307
<i>T.S. Andreychek and D.J. McDermott</i> Containment Sump Channel Flow Modelling	329

SESSION 4: INDUSTRY SOLUTIONS	339
<i>Chairpersons: Mr. A. Vandewalle, Mr. J. Butler</i>	
<i>J.-C. Delalleau, C. Delveau, G. Du Bois d'Enghien, L. Vandermeeren and J. Pirson</i>	
Actions Taken in the Belgian Nuclear Power Plants for the Resolution of the GSI-191	341
<i>J.U. Klügel</i>	
Safety Analysis Performed in Switzerland for the Resolution of the Strainer Clogging Issue	353
<i>J.R. Cavallo and A. Griffin</i>	
Original Equipment Manufacturers' (OEM) Protective Coating Design Basis Accident Testing ..	367
<i>J.W. Walker and H.L. Williams</i>	
Overview of Site Specific Blockage Solutions at US PWRs	373
<i>G. Zigler, G. Hart and J. Cavallo</i>	
LOCA Induced Debris Characteristics for Use in ECCS Sump Screen Debris Bed Pressure Drop Calculations	389
List of participants	399

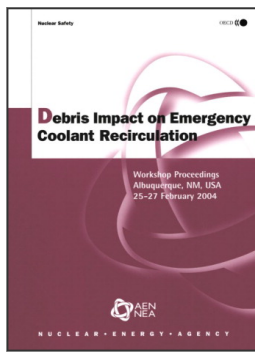

From:
Debris Impact on Emergency Coolant Recirculation
Workshop Proceedings, Albuquerque NM, USA, 25-27
February 2004

Access the complete publication at:
<https://doi.org/10.1787/9789264006676-en>

Please cite this chapter as:

Klügel, J. U. (2004), "Simple Evaluation Model for Long Term Debris Transport Velocity in the Torus of a Mark I Containment", in OECD/Nuclear Energy Agency, *Debris Impact on Emergency Coolant Recirculation: Workshop Proceedings, Albuquerque NM, USA, 25-27 February 2004*, OECD Publishing, Paris.

DOI: <https://doi.org/10.1787/9789264006676-20-en>

This work is published under the responsibility of the Secretary-General of the OECD. The opinions expressed and arguments employed herein do not necessarily reflect the official views of OECD member countries.

This document and any map included herein are without prejudice to the status of or sovereignty over any territory, to the delimitation of international frontiers and boundaries and to the name of any territory, city or area.

You can copy, download or print OECD content for your own use, and you can include excerpts from OECD publications, databases and multimedia products in your own documents, presentations, blogs, websites and teaching materials, provided that suitable acknowledgment of OECD as source and copyright owner is given. All requests for public or commercial use and translation rights should be submitted to rights@oecd.org. Requests for permission to photocopy portions of this material for public or commercial use shall be addressed directly to the Copyright Clearance Center (CCC) at info@copyright.com or the Centre français d'exploitation du droit de copie (CFC) at contact@cfcopies.com.